

MATERIALS & SPECIFICATIONS

INSULATOR:  
THERMOPLASTIC PER MIL-  
M-24519, TYPE GLCP-30F  
OR GST-40F NATURAL

CONTACT:  
COPPER ALLOY PER MIL-  
DTL-32139. GOLD PLATED  
PER ASTM B488, (HARD  
GOLD) TYPE II CODE C  
CLASS 1.27

TERMINATION:  
SOLDER COATED PER J-  
STD-006 OR PLATED PER  
AMS-P-81728

GUIDE POST:  
BERYLLIUM COPPER ALLOY  
PER ASTM B196.  
ELECTROLESS NICKEL PER  
SAE-AMS-2404

CURRENT CAPACITY:  
1 AMP MAX PER MIL-DTL-  
32139

CONTACT RESISTANCE:  
71 MILLIOHMS (71mV) MAX  
@ 1.0 AMPS PER MIL-DTL-  
32139



ACTUAL SIZE

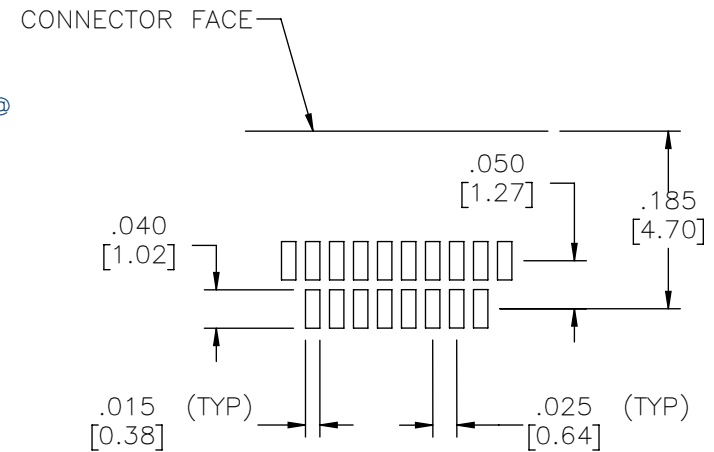
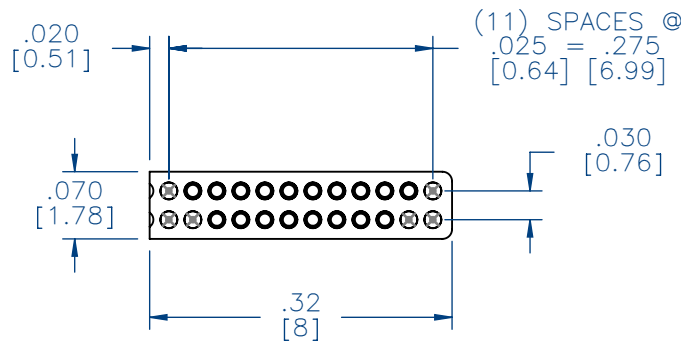

SUGGESTED PAD  
LAYOUT

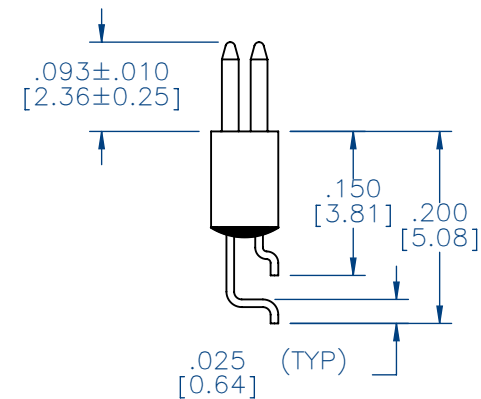
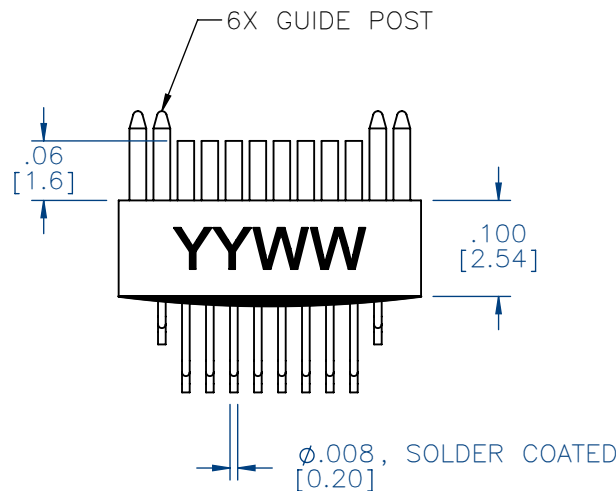

NOTE:

DIMENSIONS IN [ ] ARE IN  
MILLIMETERS UNLESS  
OTHERWISE NOTED AND ARE  
FOR REFERENCE ONLY

NSD	THIRD ANGLE
	—TOLERANCES— UNLESS OTHERWISE NOTED
MGTS	DIMENSIONS IN INCHES
	2 PL DEC ± .01
	3 PL DEC ± .005
	4 PL DEC ± .0005
	ANGLES ± 1°

THIS DRAWING CONTAINS CONFIDENTIAL AND PROPRIETARY INFORMATION WHICH IS THE PROPERTY OF OMNETICS CONNECTOR CORP. THIS DOCUMENT MAY NOT, IN WHOLE OR IN PART, BE DUPLICATED, OR DISCLOSED FOR ANY PURPOSE, WITHOUT WRITTEN PERMISSION FROM OMNETICS CONNECTOR CORP.	
DFTM. TLM	DATE 09-18-08
CHK'D.	DATE
APP'D.	DATE

TITLE:  
**(18) SOCKET FEMALE DUAL  
ROW NANO CONNECTOR  
W/GUIDE POSTS**

**OMNETICS**  
CONNECTOR CORPORATION  
7260 COMMERCE CIRCLE EAST  
MINNEAPOLIS, MN 55432  
WWW.OMNETICS.COM

CAGE CODE <b>61873</b>
DWG NO. <b>A79017-001</b>
SHEET 1 OF 1
SCALE: 5:1
REV D

PART NO. A79017-001	REV ECO	DATE 11-07-13	APP TLM
	D 100016		